



15039

Pin & Bushing Adapter

// Safety Warning

Read all instructions and safety warnings prior to operation.

Failure to do so could result in equipment damage, personal injury, or even death.

CAUTION: Failure to check the spherical thrust washer and replace as necessary may result in unrepairable damage to your u-joint puller glove casting. Preventative maintenance as outlined below will ensure many years of use from your tiger tool puller. Failure to perform preventative maintenance will void your warranty.

- Stay Alert! Watch what you are doing and use common sense when operating this tool.
- Inspect product for damage prior to using; do not use if product is in unsafe condition.
- Do not operate tool while under the influence of drugs, alcohol, or medication.
- Always use safety equipment to prevent injuries. Approved face and eye protection must always be worn by the operator, as well as others in the work area.
- Do not overreach. Keep proper footing and balance at all times.
- Dress properly. Do not wear loose clothing or jewelry.
- Keep your hair, clothing and gloves away from moving parts.
- Keep hands clear of all pressurized hydraulic components.
- Always ensure hoses are free from sharp bends and kinks.
- Keep your work area clean and well lit.
- Cylinders are designed for 10,000 psi (700 bar) maximum working pressure. Do not connect to a pump with a higher rated pressure. Use a pressure gauge in the system at all times. Ensure all components in the system are rated for 10,000 psi (700 bar).

Tiger Tool International Incorporated Limited Warranty and Exclusion of Liability. For more information, visit tigertool.com

Warranty Coverage

Tiger Tool International Incorporated ("Tiger Tool") offers a Lifetime Warranty on its branded tools (the "Lifetime Warranty") and a 2-year warranty on its branded hydraulic components (the "2-Year Warranty") to customers who purchase from Tiger Tool or its Authorized Dealers. The Lifetime Warranty and the 2-Year Warranty (referred to together as the "Warranty") cover defects in materials and workmanship.

Exclusions and Limitations of Liability

The Warranty only applies to new tools or hydraulic components owned by the original customer and used according to the specific instructions for use provided by Tiger Tool with the product.

The Warranty excludes tools and hydraulic components subjected to abnormal use, misuse, accidents, modifications, neglect, or lack of maintenance.

Tiger Tool's liability for any Warranty claim is limited to repairing the tool or hydraulic component, replacing it, or refunding the purchase price at its sole discretion. Tiger Tool reserves the right to change the design, material, and construction of its tools and components, and to discontinue any tool or hydraulic component, at any time without notice.

The Warranty is the only warranty and exclusive remedy available to the customer. Tiger Tool is not liable for any other damages or claims relating to or arising from any alleged defect in materials or workmanship, including economic loss, bodily injury, property damage, or indirect or consequential damages such as lost profits, revenues, sales, business opportunities or goodwill, or business interruptions or delays, special damages, costs, or interest. Tiger Tool and the customer agree that the implied warranties in section 18 of the Sale of Goods Act do not apply.

If Tiger Tool denies a Warranty claim, the customer must retrieve the tool at their own expense within four months of notice of the denial. Tiger Tool will attempt to contact the customer three times during this period. After four months, the customer forfeits any claims or interests in the tools.

Disputes arising from this Warranty or related to the sale or use of a tool will be governed by the laws of British Columbia and adjudicated in Vancouver, B.C. Canada, by a sole arbitrator under the Arbitration Act.

Warranty Claims

To make a Warranty claim, customers must obtain an RMA from our website (www.TigerTool.com) and then send the tool to one of the specified addresses, pre-paid and insured at their own expense.

US Returns: Tiger Tool 115 First Street PMB-T75520, Sumas, WA 98295

Canada Returns: Tiger Tool 160-34434 McConnell Road, Abbotsford, B.C., V2S 7P1



To make a return or to learn more about the Tiger Tool Return Policy, scan or visit tigertool.com/policies/refund-policy

TIGER TOOL

Canada
160-34434 McConnell Road,
Abbotsford, BC V2S 7P1

USA
115 First Street, PMB-T75520
Sumas, WA 98295



Call or text Technical Support.

1.800.661.4661

Operating Instructions

NOTE: Hammering this tool will void your warranty.

Bushing Removal

- 1** Insert the Threaded Rod through the bushing. Attach the Remover Adapter flush with the end of the rod. **(Figure A)**
- 2** Attach the Cylinder Adapter (15001-143) with its Face Plate (15001-92) to the Tiger Tool Hydraulic Cylinder. Then, position it over the Threaded Rod. **(Figure B)**
- 3** Align the assembly and screw the Hex Nut (15001-98) into place, making sure the step is facing the Hydraulic Cylinder. **(Figure C)**
- 4** Connect the airline to the cylinder using the threading plug and socket.
- 5** Apply hydraulic pressure, ensuring the bushing and the Remover Adapter exit the bore without obstruction. If the Hydraulic Cylinder reaches its maximum stroke of 2 inches **(Figure D)**, release the pressure. Then, tighten the Hex Nut and reapply hydraulic pressure until the bushing is completely removed. **(Figure E)**
- 6** Repeat step 5 until bushing is released.
- 7** Once the bushing is released, remove it and disassemble the tooling.

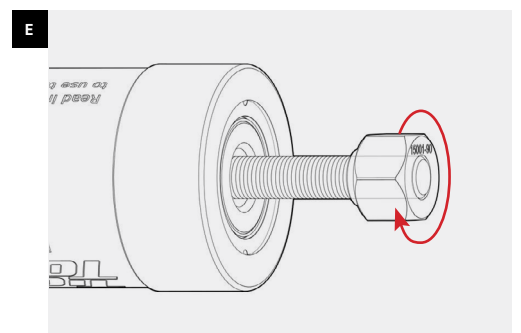
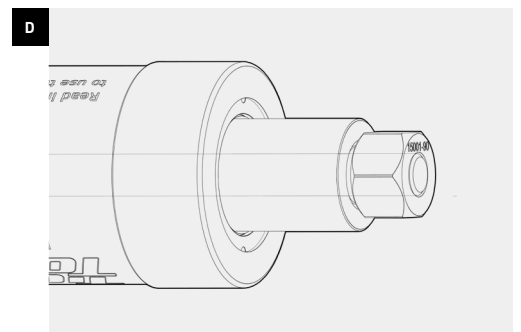
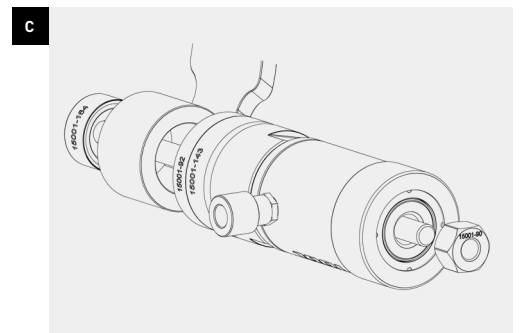
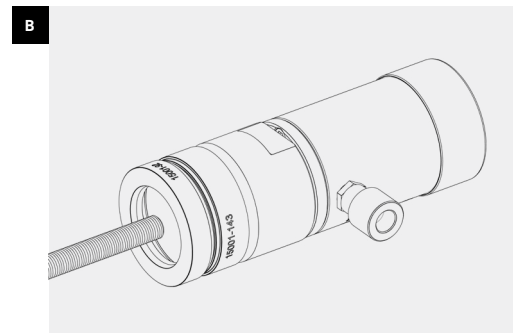
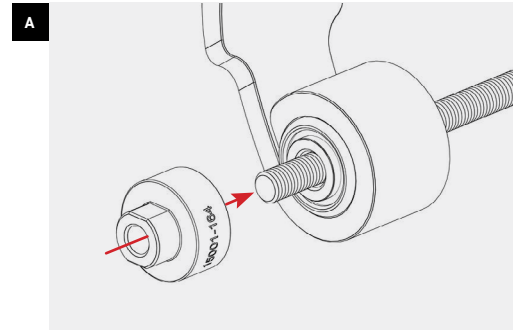

Operating Instructions

Bushing Installation

- 1 Insert the Threaded Rod through the spring.
- 2 Place the new bushing onto the inboard side of the threaded rod. Attach the Installer Adapter flush with the rod's end, trapping the bushing between the spring and the adapter. **(Figure A)**
- 3 Attach the Cylinder Adapter (15001-143) with its Face Plate (15001-92) to the Tiger Tool Hydraulic Cylinder (not supplied).
- 4 Position the Hydraulic Cylinder assembly on the outboard side of threaded rod until it is flush with the spring bore.
- 5 Align the assembly with the new bushing seated between the Installer Adapter and the bore. Screw the Hex Nut onto the Threaded Rod, ensuring the step faces the Hydraulic Cylinder. **(Figure B)**
- 6 Connect the airline to the cylinder using the threading plug and socket.
- 7 Apply hydraulic pressure, checking that the bushing enters the bore straight. Upon reaching the maximum stroke (2 inches) of the Hydraulic Cylinder, release the pressure, tighten the Hex Nut, and reapply hydraulic pressure until the bushing is fully seated against the Installer Adapter, causing the hydraulic cylinder to stop. **(Figure C / D)**
- 8 Disassemble the tool and check the bushing for a successful installation. Clean the tooling and return it to its case.

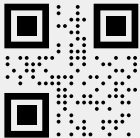
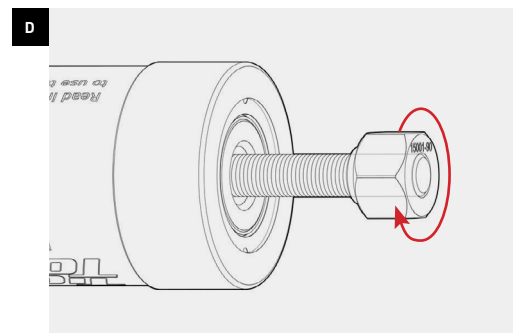
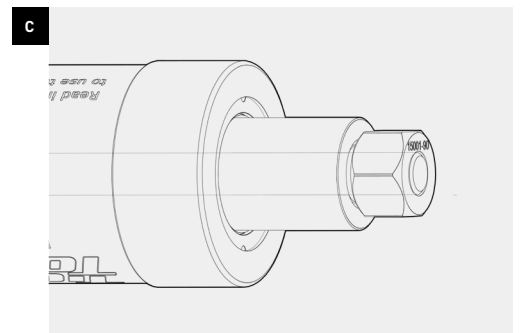
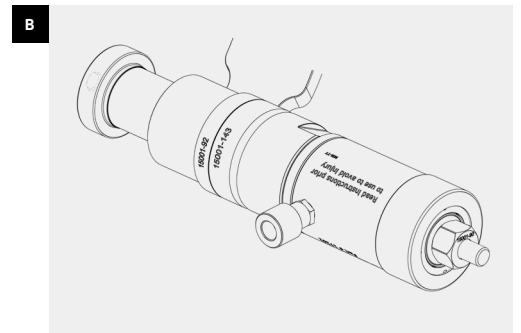
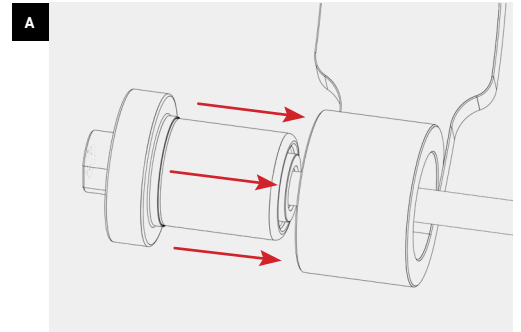

Need some assistance with your Tiger Tool?

No worries! Scan this QR code with your phone to start texting with someone who can help out.

1.800.661.4661

Parts Breakdown

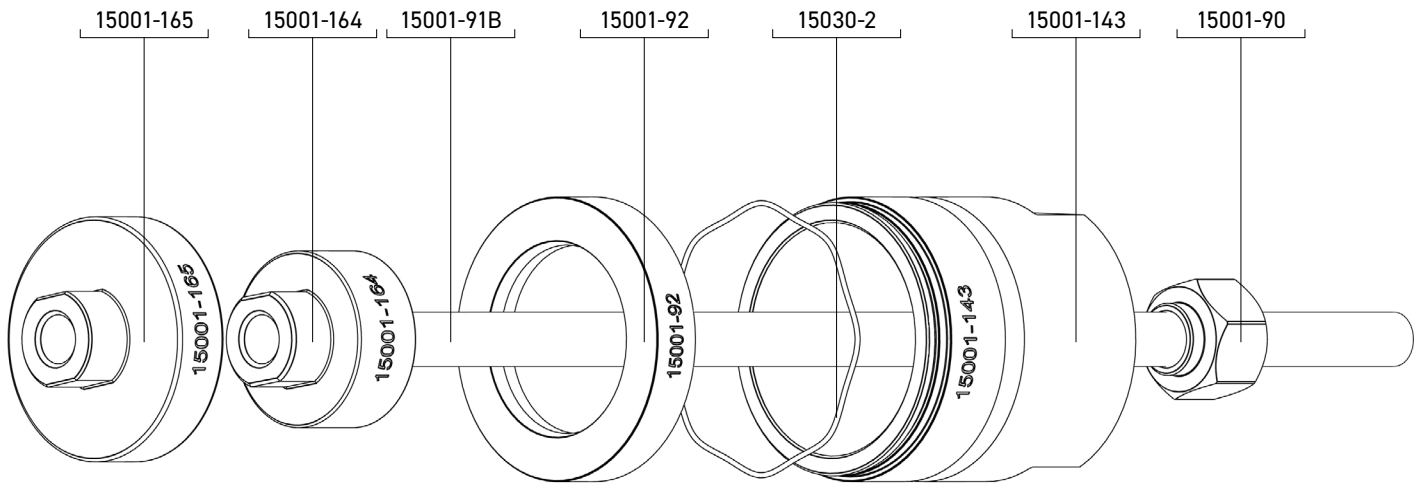

Part Number	Description	Qty.
15001-91B	3/4" Threaded Rod 20"	1
15001-164	Remover	1
15001-165	Installer	1
15001-90	Hex Nut	1
15001-143	Receiver Tube	1
15001-92	Wear/Face Plate	1
15030-2	External Snap Rin	1

